

The Rocky Mountain Survivor Queenbee Cooperative 2011-2014

Project #FW12-096

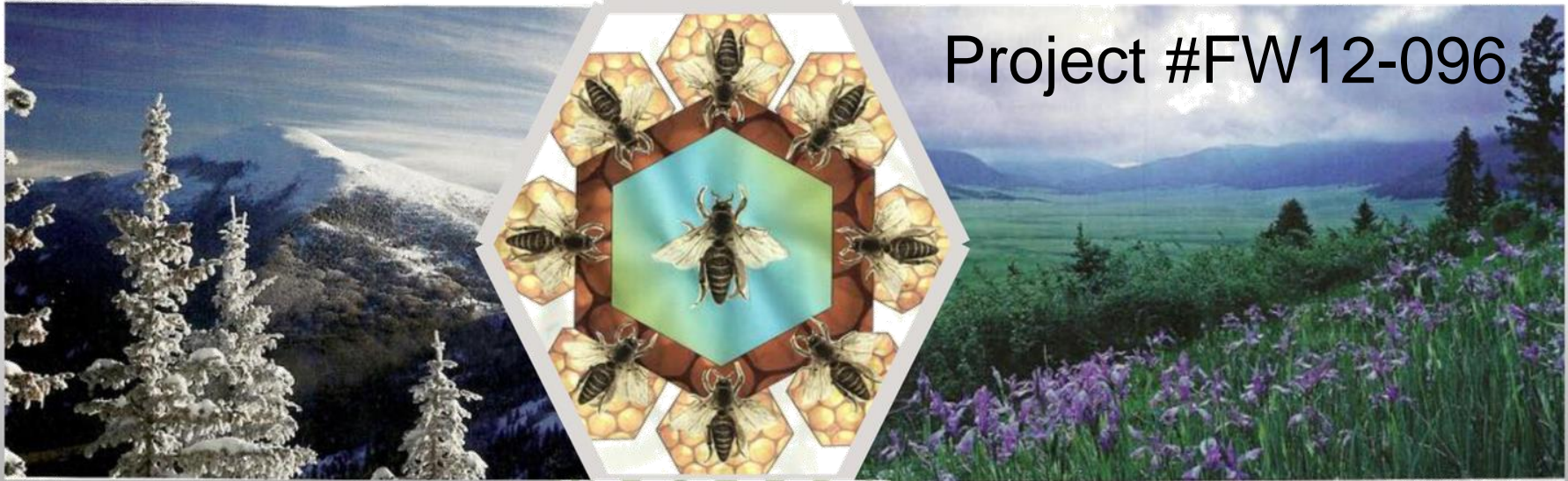

WESTERN
SARE
Sustainable Agriculture
Research & Education



7 Counties: 3 in CO & 4 in NM

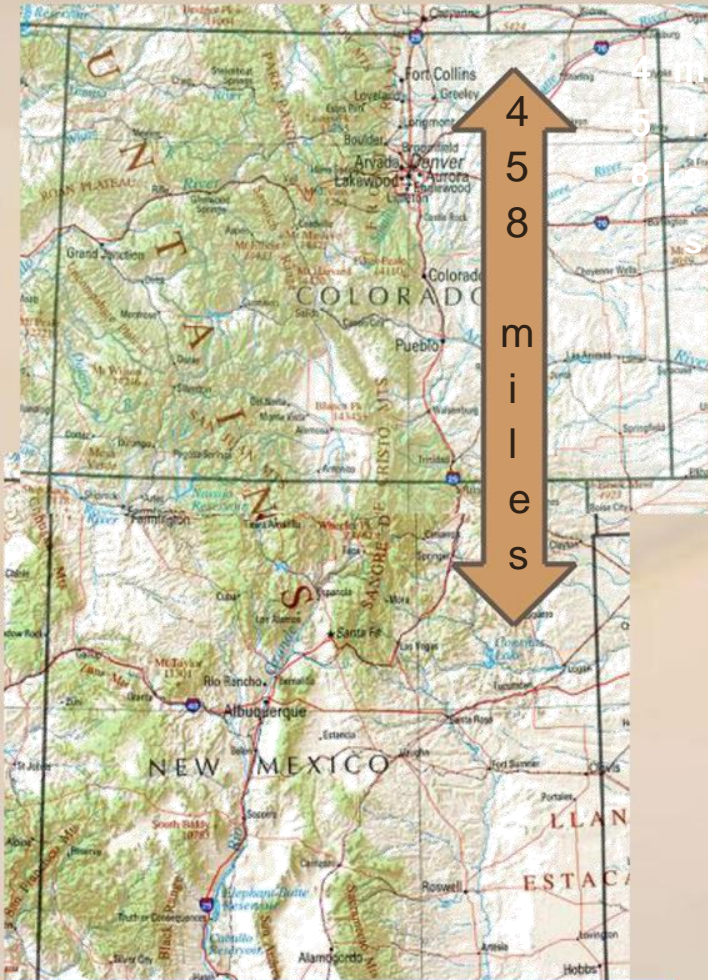

<u>COUNTY</u>	<u>BEEKEEPER</u>	<u>COMMUNITY</u>
Larimer , CO	Kris Holthaus	Ft. Collins
Arapaho , CO	Marygael Meister	Denver
Huerfano , CO	Janet Fink	Walsenburg
Rio Arriba, NM	Melanie Kirby	Truchas
Mora , NM	Meg McGee	Mora
Mora, NM	Resa Sawyer	Buena Vista
Taos , NM	Moira O'Hanlon	Arroyo Seco
Taos, NM	Angela Lewis	Arroyo Hondo
Santa Fe, NM	Kate Whealen	Santa Fe

5000' to 8000' Elevation

These WSARE projects have encouraged additional case studies across the United States

West

East

- ❖ Bonnie Bee- Bonnie & Gary Morse- Marin, CA
- ❖ Wings of Nature- Aiden Wing-Palo Alto, CA
- ❖ Valley of the Giants- Seth Rick- Humbolt, CA
- ❖ Davis Family Apiaries- Porterville, CA
- ❖ Old Sol- John Jacob- Corvallis, OR
- ❖ Olympic Wilderness Apiaries- WA
- ❖ Kris Holthaus- CO
- ❖ Zia Queenbees- NM/MI/CA
- ❖ Wings of Nature Bees- CA

- ❖ Champlain Valley Bees & Queens-Kirk Webster- VT
- ❖ VP Bees- Adam Finkelstein- MD
- ❖ Anarchy Apiaries- Sam Comfort- NY-VA-FL
- ❖ Sweet Meadow Farm- Steve Repasky- PA
- ❖ Dr. Vincent Aloyo & Scott Famous- PA
- ❖ USDA-ARS Baton Rouge- Dr. Jose Villa- LA...CO
- ❖ Texas A&M Rangel Bee Lab- Dr. Juliana Posada-Rangel
- ❖ Dr. Megan Milbraith- MI
- ❖ Purdue Ankle-Biters, Indiana
- ❖ Russian Bee Breeders Association...



Large Scale- Small Scale Potential



Urban Beekeeping Breeding Efforts





A SYMBIOTIC RELATIONSHIP

Consilience : the linking together of principles from different disciplines especially when forming a comprehensive theory

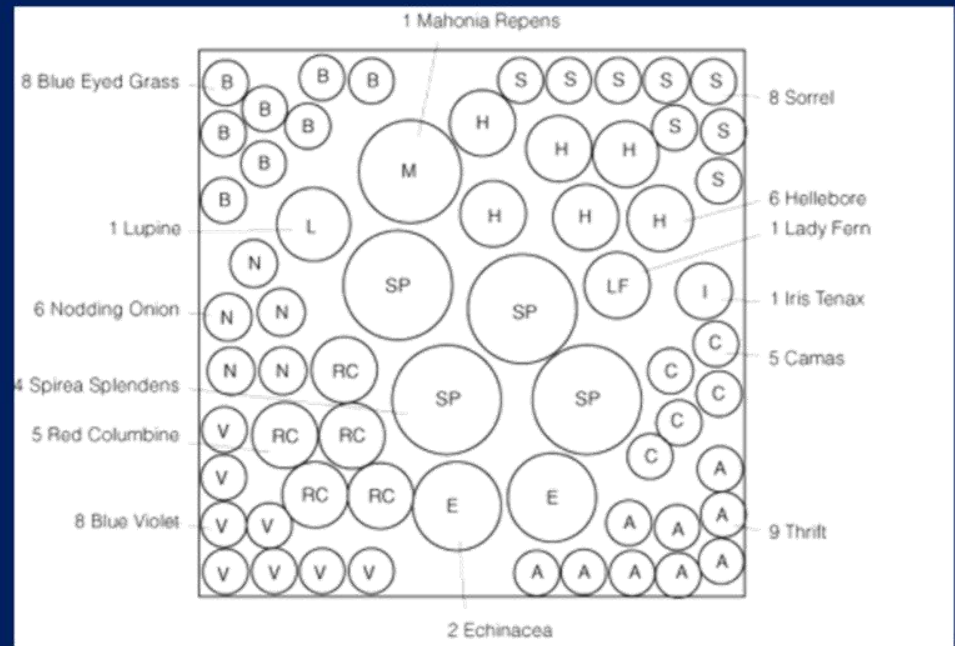

*Wild hedgerows, NM Acequias, Riparian zones,
medians/pollinator corridors, urban farms,
school and community gardens, open spaces...*

Benefits of Biodiversity



***Following bloom*Pollination*Reforestation*Nutrition**

Organismal Health/Network of Health/Nutritional Habitat & Products

BIOMIMICRY...inspired by nature



Healthy Products



Botany & Medicine



Community



Healthy Organisms



Nutrition/ Food



An Integrative Approach



As Stewards of our Lands, Resources & Health: It is imperative for us to be proactive in researching and implementing sustainable management practices & techniques to better secure our industry and our livelihoods.





**Lessons Learned:
From the Bees,
From Farmers &
Beekeepers, From
Scientists...
Thanks to WSARE!**

TIME & SEASONS

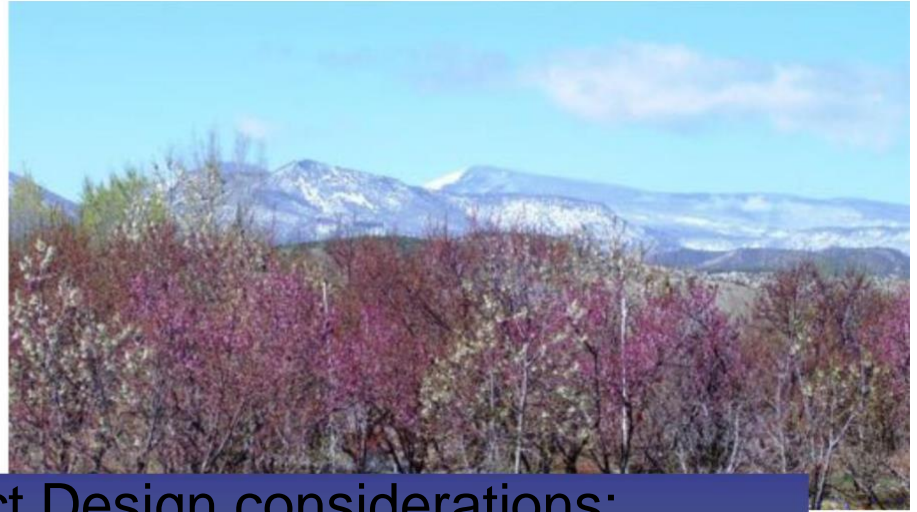

Project Design considerations:
Location- Weather- Timing of Objectives
Participants- Outreach- Reporting



For Example:

Timing of objectives should match best calendar times so that outcomes are successful.



Spring:

*initial build-up period,
swarming, volatile weather,
creating a workforce,
nutrition*



Summer:
Population Explosion
Wax Production
Honey Supers



Fall:
Protein/ Pollen stores
Mite assessment
Creating Fat-
Winter Bees



Winter:
Overwintering Tactics
Death

Things to keep in mind when applying for WSARE grants:

- **Decide on realistic goals that can be accomplished in the time frame.**
- **Start application early so that supporting documentation can be uploaded before deadline.**
- **If working with additional producers/farmers- be sure they are committed to participate for the duration of the project.**
- **Document as much as possible to share via websites, publications, presentations and outreach events.**



- **Be sure to invite the community (direct audience and other interested community members) to learn about your project as they can help to spread the word and potentially offer support for the project.**



- **Don't be shy to ask questions, do research and network with scientists and institutions who may have complimentary information for your project.**
- **And most important- Enjoy the process! It can be a fun experience for all involved!**

Stewardship: An Endless Road with many interpretations



Melanie Kirby- “Beekeeping is truly a humbling profession for me. I am routinely inspired by my many mentors: the honeybees, Mother Nature and numerous beekeeping and non-beekeeping acquaintances, scientists, extension agents, and more...

The mystery is the allure!”

Learning from Nature



**THANK YOU FOR
YOUR ATTENTION!**

Working with Nature



Melanie Kirby

Email:

ziaqueenbees@hotmail.com